

SHW OFFROAD

## Ford Bronco Drawer System Install

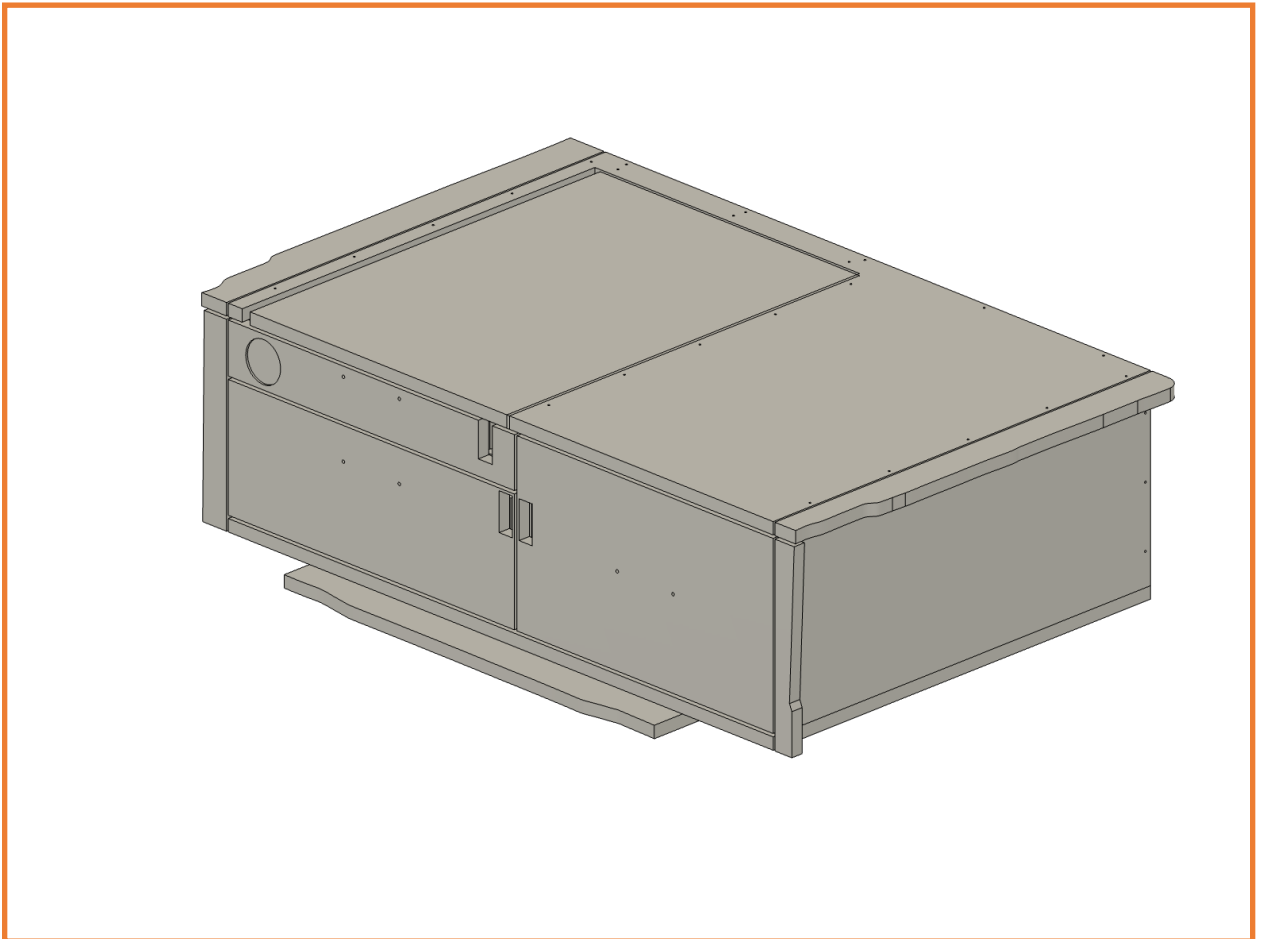

1. Begin by removing the factory tie downs.
2. **Optional:** Take a blade to the factory carpet hinge at the storage cover. This will allow access to the area without having to remove the drawer system. Cut through the carpet to remove the compartment lid/cover.
3. **Optional:** Drill out the tailgate side factory plastic tie down covers so that the anchoring bolts can be installed through them. This step retains a slightly more factory look.
4. Install one of the drawer system front filler panels.

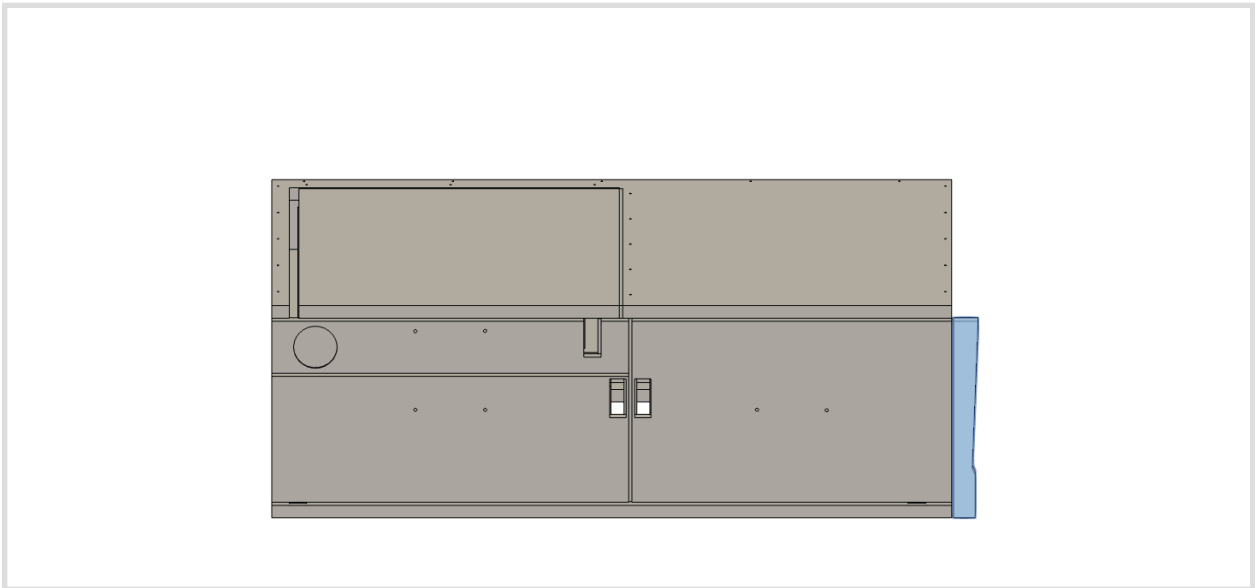

5. Slide the drawer system into the vehicle. Center the drawer system in the vehicle using the wings to position the unit.
6. Install the remaining filler panel. The holes are predrilled and the fasteners should be threaded loosely into the filler plate upon receipt. You will need a Torx bit and an impact driver.

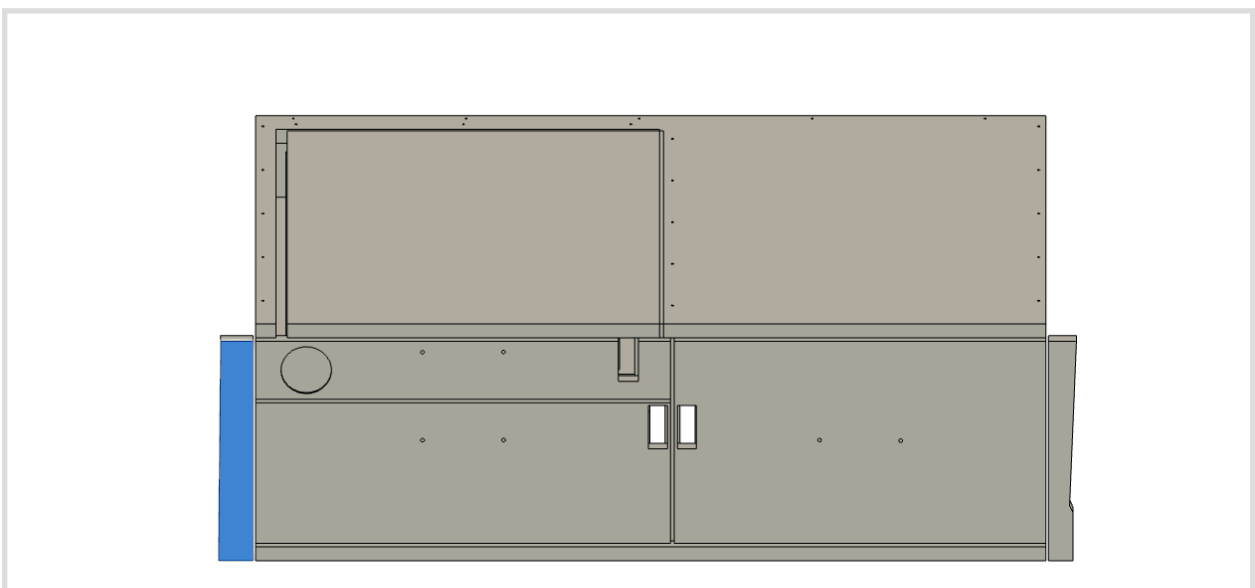

7. Line up the front support bar and drive four screws to anchor it to the drawer system. This step is only necessary if performed optional step #2. Use the included square head screws and fasten the drawer system to the filler plate once alignment is achieved. You **MUST** install this support bar if you remove the cover in step #2.

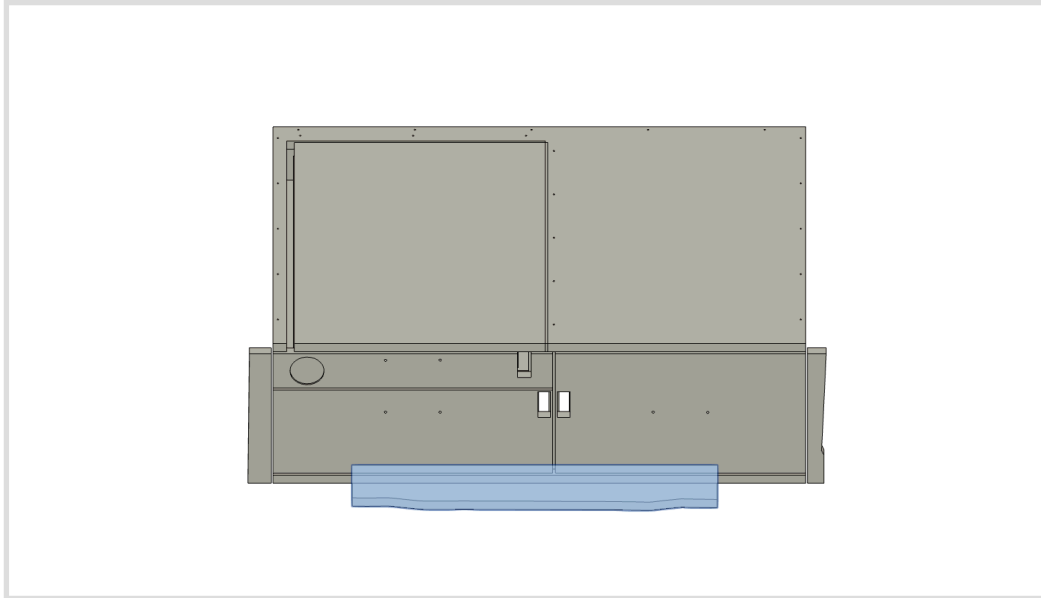

8. Install the included bolts through the bolt holes in the drawer system and into the factory threaded holes where the factory tie downs were installed. The drawers will have to be removed from the drawer chassis to complete this step. Torque each corner bolt down one at a time, they only need to be snug.
9. Install the wings.

