

# SHW OFFROAD

## 3rd Gen Tundra Seat Delete Install

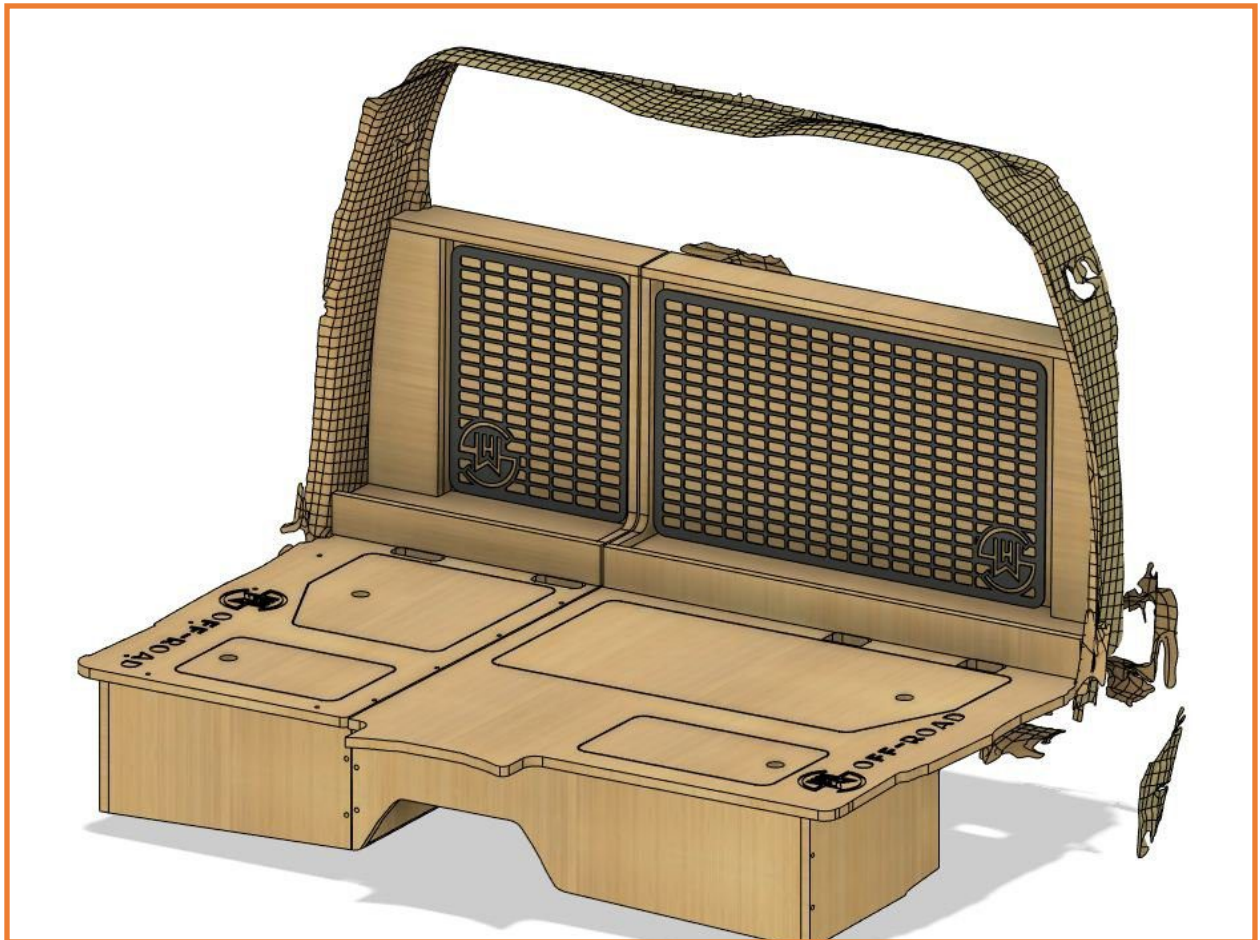

1. Uninstall seats (and back trim panels if installing the wall as well). The OEM storage bin stays in place for the install.
2. The assembly process is the same for each seat delete sections. Be sure to assemble the sections inside the truck cab. We like to start with the 60% section.
3. Install the nutserts into the back holes of the seat frame. (this can also be done later). A nutsert tool is not required, search "How to Install a nutsert without a nutsert tool" on Google to learn more. Be sure to line the seat delete top up with the frame before tightening the outserts to make sure the correct holes line up.
4. Remove the lids and set them aside.
5. Start by placing the side supports and front support into position. Loosely Install the screws into the threaded inserts. The 60% is shown below.

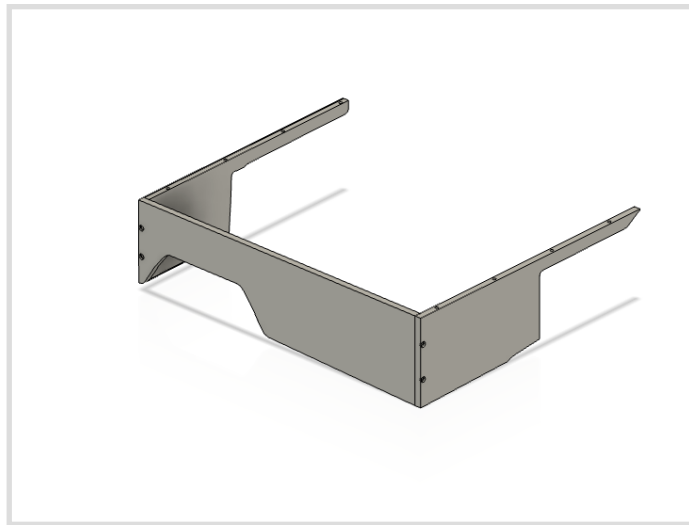

6. Place the top platform into position and loosely install the screws into the threaded inserts.

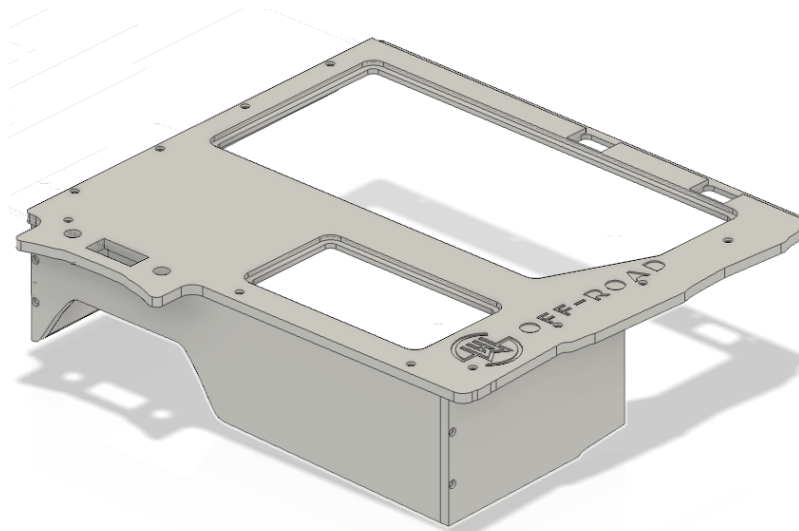

7. Place 5 washers between the seat delete top and frame at each nutsert location to level the platform. Loosely install screws into the nutserts in the seat frame.
8. Once all the holes are lined up and the screws are started, start tensioning the screws individually. The screws do not need to be much past hand tight.

#### W/Optional Back Wall

9. The seat delete(s) must be installed before the back wall(s). Place the 60% back wall in the vehicle, taking care not to hit the OEM sub if equipped.
10. Install the OEM seat bolt to anchor the bottom of the seat delete.

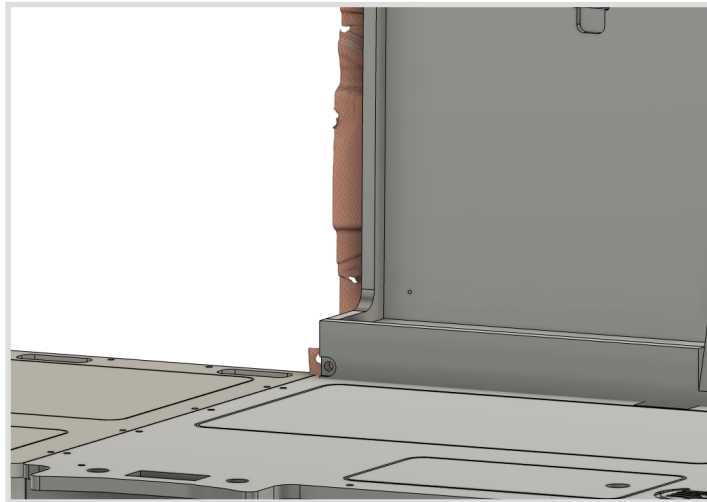

11. Place the included retainer bar between the OEM anchor loop and seat delete back. Screw the retainer bar into place. This keeps the back wall from folding forward.



12. Install the MOLLE panels using the included screws.

13. Enjoy your seat delete system!

As always, call 859-749-8588 with any questions.