

SHW OFFROAD

## 5th Gen RAV4 Drawer System Install

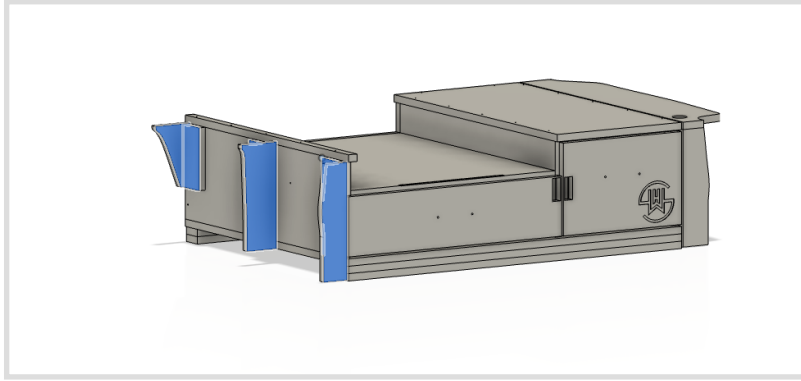

1. Install the fridge side wing supports and wing cap. The fridge side wing supports will be in the fridge side drawer. Use the existing holes to line it up so that the wing sits flush with the top of the drawer system. Place wing on the supports to make sure it is flush with the top and adjust if needed. The screws are installed from the outside of the drawer system on the fridge side.



2. Slide the drawer system into the vehicle. Be careful with the wing cap on the fridge side. You will need to lift the drawer system over the hatch-side hump. It is best to have a second person help handle the drawer system from the rear door with the seats folded down.
3. Install the opposite side wing supports once the system is in the vehicle. The screws need to be driven from the inside, so remove the opposite side drawer by separating the drawer slide. This is done by pulling the drawer all the way out, activating the locking switch, then activating the small black tab on the side of the non locking slide. Start the screws in the drawer system side allowing the screw to protrude just slightly. Grab your supports and line up the existing holes with the protruding screw. Start with the front and back supports, then do the middle. Adjust the height of the supports as needed. You may find multiple holes in your supports as we have already installed and adjusted them during assembly.



4. Loop the included blue cargo straps through the D Rings on the drawer system and the factory tie downs. Snug each corner one at a time, then go back and tighten them down. Once in place and tightened, cut the excess strap away and use a flame to melt the strap end to keep it from fraying
5. Enjoy your drawer system!